

# STREAMLINED SHAFT ANODES / imperial

**Easy installation underwater.**

Bolt retaining washers prevent the anode from falling off. Choose from two of our stainless steel hardware options:



Allen head w/ lock washer & bolt retaining washer



Slotted head w/ lock washer & bolt retaining washer (add S to the PID)

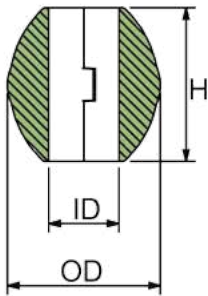

**CMX00-CMX09**

- Interlocking halves

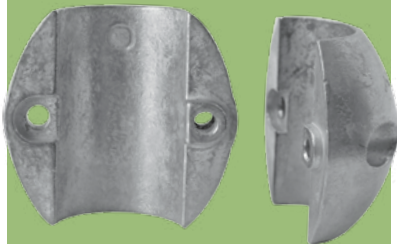

- Full shaft contact (100% CIRCULAR RADIUS)
- Extra alloy around fastener

	PID	LB	KG		H	OD	ID	UPC
Al	CMX00A	0.126	0.098	mm	50	42	12	6 28309 24256 5
Mg	CMX00M	0.145	0.066					6 28309 18277 9
Zn	CMX00	0.525	0.238	in	1.95	1.64	0.5	6 28309 12220 1
Al	CMX01AL	0.31	0.14	mm	51	52	19	6 28309 12752 7
Mg	CMX01M	0.22	0.10					6 28309 12771 8
Zn	CMX01	0.85	0.38	in	2	2.04	0.75	6 28309 10365 1
Al	CMX018125AL	0.31	0.14	mm	50.8	51.8	20.63	6 28309 12751 0
Zn	CMX018125	0.75	0.34	in	2	2.04	0.8125	6 28309 12350 5
Al	CMX02AL	0.34	0.15	mm	53	54	22.22	6 28309 12753 4
Mg	CMX02M	0.25	0.11					6 28309 12772 5
Zn	CMX02	0.95	0.43	in	2.08	2.12	0.875	6 28309 10366 8
Al	CMX03AL	0.36	0.16	mm	55	55	25	6 28309 12626 1
Mg	CMX03M	0.25	0.11					6 28309 11534 0
Zn	CMX03	1	0.45	in	2.15	2.16	1	6 28309 10367 5
Al	CMX04AL	0.43	0.19	mm	57	60	28.57	6 28309 12755 8
Mg	CMX04M	0.3	0.13					6 28309 12773 2
Zn	CMX04	1.16	0.526	in	2.25	2.36	1.125	6 28309 10368 2
Al	CMX05AL	0.46	0.208	mm	60	61	32	6 28309 12756 5
Mg	CMX05M	0.3	0.13					6 28309 11535 7
Zn	CMX05	1.18	0.535	in	2.35	2.42	1.25	6 28309 10369 9
Al	CMX05AAL	0.71	0.32	mm	62	68	32	6 28309 24257 2
Mg	CMX05AM	0.47	0.21					6 28309 24386 9
Zn	CMX05A	1.75	0.79	in	2.45	2.68	1.25	6 28309 10370 5
Al	CMX06AL	0.58	0.263	mm	60	67	34.92	6 28309 12757 2
Mg	CMX06M	0.38	0.17					6 28309 12774 9
Zn	CMX06	1.50	0.680	in	2.35	2.66	1.375	6 28309 10371 2
Zn	CMX0625	0.70	0.32	mm	50.8	48.76	15.87	6 28309 15714 2
				in	2	1.92	0.625	
Al	CMX07AL	0.66	0.299	mm	63	70	38	6 28309 12758 9
Mg	CMX07M	0.42	0.19					6 28309 12775 6
Zn	CMX07	1.70	0.771	in	2.5	2.78	1.5	6 28309 10372 9
Al	CMX08AL	0.95	0.43	mm	73	82	44	6 28309 12759 6
Mg	CMX08M	0.64	0.29					6 28309 12776 3
Zn	CMX08	2.4	1.09	in	2.75	3.25	1.75	6 28309 10373 6
Al	CMX09AL	1.17	0.53	mm	73	82	51	6 28309 12760 2
Mg	CMX09M	0.80	0.36					6 28309 12777 0
Zn	CMX09	2.97	1.347	in	2.9	3.6	2	6 28309 10374 3

**SHAFT & RUDDER ANODES**

Choose  
Aluminum

**Al premium**  
SALT AND BRACKISH WATER

Anodes for  
salt and brackish  
water and  
Magnesium

**Mg fresh**  
FRESH WATER ONLY  
for freshwater.

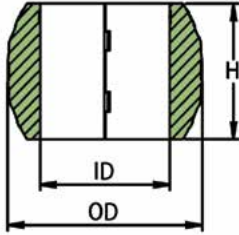

CMX10-CMX21

**Martyr**  
SHAFT & RUDDER ANODES

## STREAMLINED SHAFT ANODES / imperial

PID		LB	KG		H	OD	ID	UPC
Al	CMX10AL	2.464	1.117	mm	95	106.1	57	6 28309 12761 9
Mg	CMX10M	1.608	0.729	in	3.75	4.18	2.25	6 28309 22963 4
Zn	CMX10	6.214	2.818					6 28309 10375 0
Al	CMX11AL	2.142	0.971					mm
Mg	CMX11M	1.404	0.637	in	3.75	4.18	2.5	6 28309 19129 0
Zn	CMX11	5.382	2.441					6 28309 10376 7
Al	CMX12AL	2.996	1.359					mm
Mg	CMX12M	1.964	0.891	in	3.625	4.8	2.75	6 28309 24387 6
Zn	CMX12	7.539	3.420					6 28309 10377 4
Al	CMX13AL	2.665	1.209					mm
Mg	CMX13M	1.752	0.795	in	3.625	4.8	3	6 28309 24388 3
Zn	CMX13	6.673	3.027					6 28309 10378 1
Al	CMX14A	2.87	1.30					mm
Mg	CMX14M	1.88	0.86	in	4.17	4.8	3.25	6 28309 23835 3
Zn	CMX14Z	7.21	3.27					6 28309 23836 0
Al	CMX15AL	3.642	1.652					mm
Mg	CMX15M	2.372	1.076	in	3.78	5.55	3.5	6 28309 24389 0
Zn	CMX15	9.211	4.178					6 28309 12232 4
Al	CMX17AL	3.51	1.59					mm
Mg	CMX17M	2.28	1.03	in	3.5	6	4.005	6 28309 24390 6
Zn	CMX17	8.91	4.04					6 28309 12223 2
Al	CMX18AL	4.859	2.204					mm
Mg	CMX18M	3.139	1.424	in	3.5	6.75	4.5	6 28309 24391 3
Zn	CMX18	12.420	5.634					6 28309 12793 0
Al	CMX19AL	3.648	1.655					mm
Mg	CMX19M	2.369	1.075	in	3.5	6.75	5	6 28309 24392 0
Zn	CMX19	9.270	4.205					6 28309 12794 7
Al	CMX20AL	6.230	2.826					mm
Mg	CMX20M	4.012	1.820	in	3.5	7.8	5.5	6 28309 23838 4
Zn	CMX20	15.957	7.238					6 28309 12795 4

### The world's best shaft anode design:

- Fit & longevity
- Easy installation underwater: bolt retaining washers prevent the anode from falling off

